

--NOTE--

NIP : New Iron Pin
OIP : Old Iron Pin
EIP : Existing Iron Pin

* Axel by Black Gum on Creek Bank

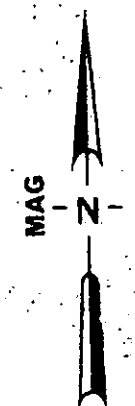

MICROFILMED

0106
088200
002880
47

CLYDE L. NESBITT
Deed 782, pg 563

A. J. FARMER

1.00 ACRES

Septic Tank

* Nail C/L Groves Meadow Rd
(Mays Bridge Rd.)

483.00

RR Spike

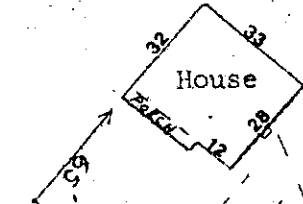

water meter

Driveway

Utility Line

Well House

RR Spike

* Power Pole

N40-15E 267.80

N43-59-20W 163.48

NIP

NIP

844.30

S43-59-20E 163.48

S40-15W 267.80

13361

8-F-54

FILED
GREENVILLE CO. S.C. ORR 8 2 100
OCT 28 3 59 PM '80
DONNIE S. TANKERSLEY
R.M.C.

I certify that I surveyed this property and found that there are no encroachments on this property and that this property does not encroach on adjoining property. This property is not located in a flood hazard area.

John R. Long

S.C. R.L.S. 6270

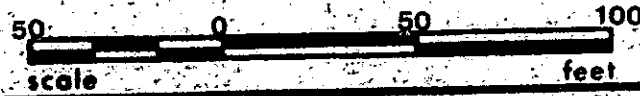

ALLEN D. & JOANI D. HELMS

DATE: 10-24-80	SCALE: 1"=50'	JOB NUMBER: 80-633-38-15
STATE: SC	COUNTY: Greenville	CITY/TOWNSHIP: O'Neal
1.00 acres cut off from Southwest corner of A. J. Farmer deed 318, pg. 14 containing 56 acres + Tax Map 641.2-25, Deed 529, pg. 490		<input type="checkbox"/> New Iron Pin <input type="checkbox"/> Existing Iron Pin
FORESTERS	JOHN R. LONG & ASSOC. 322 COLLEGE AVENUE CLEMSON, S.C. 29631	SURVEYORS (803-654-5033)